



TORONTECH™

CATALOGUE

2014

TTAAB-Series of Pulp Pumps (ISO)



PRODUCT BROCHURE

TORONTECH
PUMPS

TORONTECH.COM



TORONTECH™

Torontech™ is a leading North American based international manufacturer and supplier of pumps, pipes, valves & actuators. The Torontech™ group has established an extensive network in the USA as well as international markets and remains to be a preferred vendor of choice supplying quality pumps for today's leading corporations.

Creating comprehensive solutions for our clients has always been the core value of our company. From sales, to order execution, and post-sales support; every staff member is here to assist you in selecting the solution that best suits your unique requirements and budget.

The Torontech™ group offers a complete range of quality pumps that are, ANSI to ISO approved and engineered to last, ensuring your company continuous production without interruptions.

Since the beginning, we have succeeded in only offering quality manufactured pumps that are currently being used worldwide. We offer the best value for your investment and provide world-class support.

Due to the demand for our quality pumps, Torontech™ has experience explosive growth primarily in the oil & gas, water filtration and chemical refinery industries.

We offer an extensive range of solutions and products for oil & gas projects, refineries, petrochemical plants, and marine applications. Our main class of pumps includes API (American Petroleum Institute) Standard, Mining, Water & Sewage and Firefighting applications. The pumps are offered in various configurations depending on orientation of the pump, required head and type of fuel used for operation.



TORONTECH™

Specializing in Testing Equipment, Instruments & Supplies



TORONTECH™

Specializing in Testing Equipment, Instruments & Supplies

TTAAG

TTAAG

TTAAG-Multistage centrifugal pumps

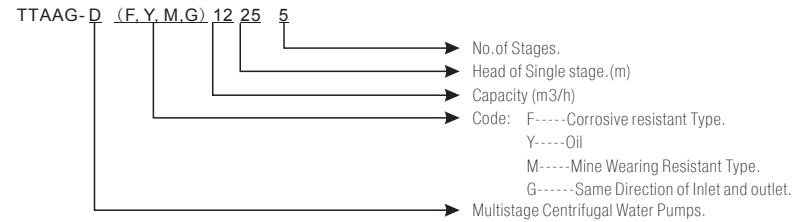

Design:
 D (F, Y, M) series: Horizontal Inlet and Vertical Upwards Outlet.
 DG series: Vertical Upwards Inlet and Outlet.
 Gaskets are used to seal the stationary joint faces of suction section, middle section, and discharge section.
 Choke Flow Seal is used between each stage and soft packing is used as shaft seal of two ends of shaft.
 Water Deflector is used together with bearing to avoid water entering into the bearing.
 The bearing on two ends of shaft is Roller bearing.
 Liquids should be free of large solid particles and fibres.

Technical Data:
 Flow: 6-740m³/h
 Head: 75-690m
 Speed: 1480rpm/2950rpm (50Hz)
 Temperature: -10°C--150°C

Fluid:

- Liquids should be free from large solid particles and fibres.
- Technical Data:
- Flow: 6-740m³/h
- Head: 75-690m
- Speed: 1480rpm/2950rpm (50Hz)
- Temperature: -10°C--150°C

Sectional Drawing and Parts List:

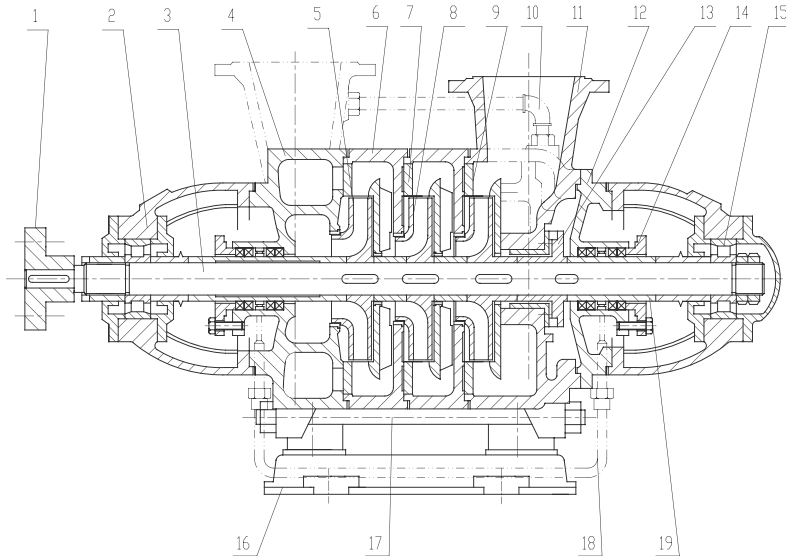

| | |
|-----------------------------|------------------------|
| 1. Bolt Flexible Coupling | 11. Outlet Section |
| 2. Bearing Body | 12. Packing Body |
| 3. Shaft | 13. Balance Plate |
| 4. Inlet Section | 14. Packing Gland |
| 5. First-Stage Impeller | 15. Bearing |
| 6. Middle Section Seal Ring | 16. Base Plate |
| 7. Guide Vane | 17. Strengthening Bolt |
| 8. Impeller | 18. Water Seal Pipe |
| 9. Final-Stage Guide Vane | 19. Shaft Sleeve |
| 10. Return Pipe | |

Performance Curve

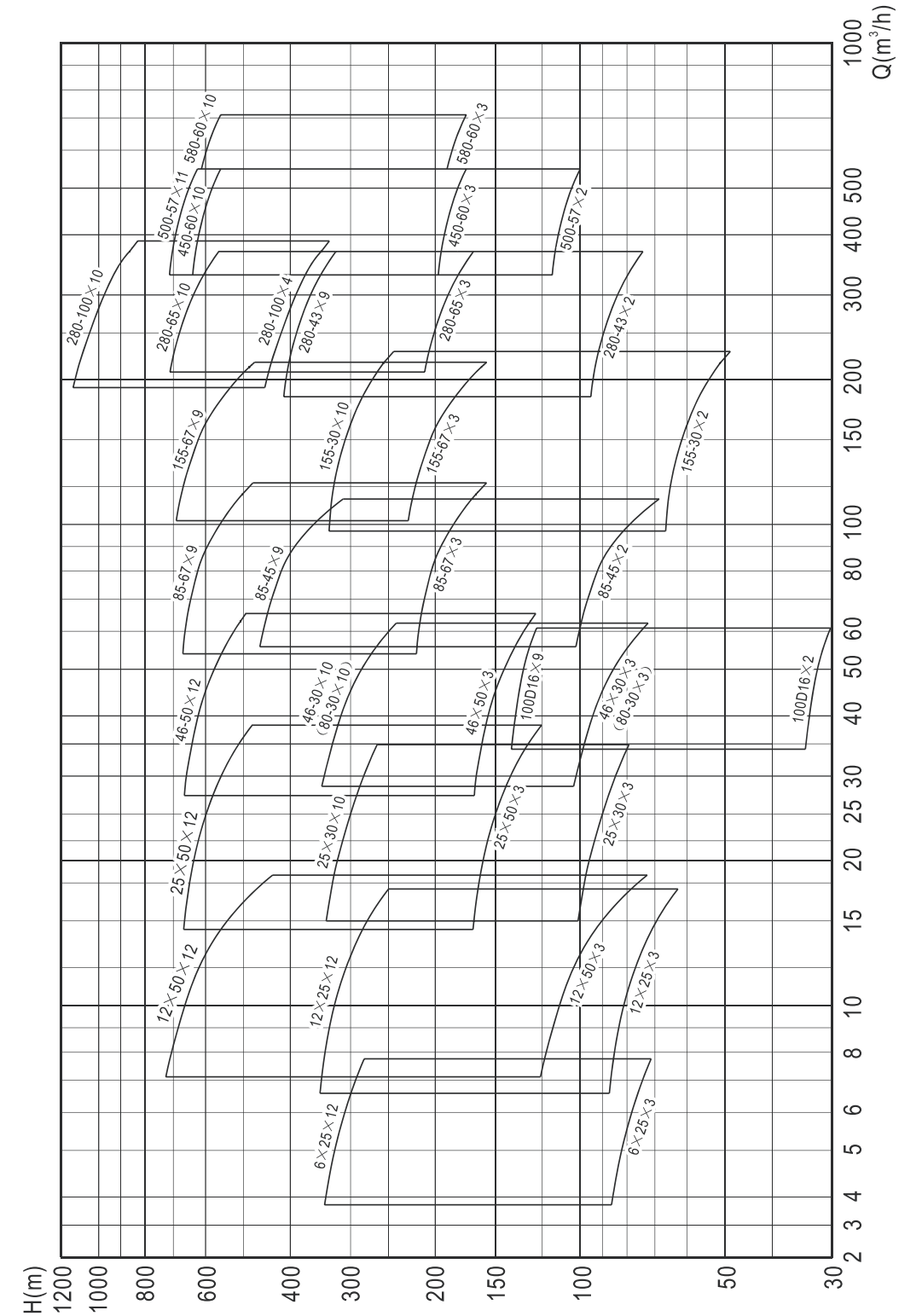

Torontech Inc. - Canada
 North American Headquarters
 Tel: +1.416.368.2721
 Fax: +1.416.981.7652
 Email: sales@torontech.com
 www.Torontech.com

Torontech Inc. - Canada
 North American Headquarters
 Tel: +1.416.368.2721
 Fax: +1.416.981.7652
 Email: sales@torontech.com
 www.Torontech.com



Flange Size Table

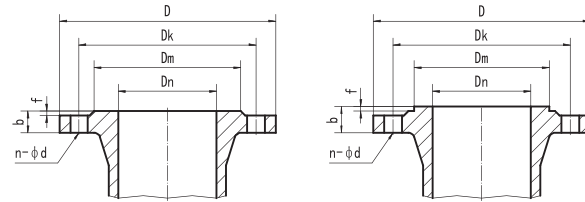

| Model | suction Flange (mm) | | | | | | | Discharge Flange (mm) | | | | | | |
|---------------------|----------------------------|-----|-----|-----|----|---|-------|-----------------------|-----|-----|-----|----|-----|-------|
| | Dn | Dm | Dk | D | b | f | n-φd | Dn | Dm | Dk | D | b | f | n-φd |
| TTAAG-D/D, DG6-25 | 40 | 80 | 100 | 130 | 18 | 3 | 4-14 | 40 | 75 | 110 | 150 | 24 | 4 | 4-18 |
| TTAAG-D/D, DG 12-25 | 50 | 90 | 110 | 140 | 18 | 3 | 4-14 | | | | | | | |
| TTAAG-D/D, DG 12-50 | 50 | 90 | 110 | 160 | 30 | 3 | 4-14 | 50 | 87 | 135 | 180 | 32 | 4 | 4-23 |
| TTAAG-D/D, DG 25-30 | 65 | 104 | 130 | 160 | 20 | 3 | 4-18 | 65 | 109 | 145 | 185 | 32 | 4 | 8-18 |
| TTAAG-D/D, DG 25-50 | 65 | 120 | 145 | 185 | 20 | 3 | 4-18 | 65 | 109 | 160 | 205 | 32 | 4 | 8-23 |
| TTAAG-D/D46-50 | 80 | 128 | 150 | 190 | 22 | 3 | 4-18 | 80 | 120 | 170 | 215 | 34 | 4 | 8-22 |
| TTAAG-D/D, DG46-30 | 80 | 128 | 150 | 190 | 22 | 3 | 4-18 | 65 | 109 | 145 | 185 | 28 | 4 | 8-18 |
| TTAAG-D/DG46-50 | Same with Discharge Flange | | | | | | | 80 | 120 | 170 | 215 | 34 | 4 | 8-22 |
| TTAAG-D/D, DG85-45 | 100 | 148 | 170 | 210 | 24 | 3 | 8-18 | 100 | 158 | 190 | 235 | 30 | 4 | 8-22 |
| TTAAG-D/D, DG85-67 | 100 | 158 | 180 | 220 | 32 | 3 | 8-18 | 100 | 149 | 200 | 250 | 36 | 4.5 | 8-24 |
| TTAAG-D/D155-67 | 150 | 202 | 225 | 265 | 26 | 3 | 8-18 | 150 | 203 | 280 | 345 | 42 | 4.5 | 8-33 |
| TTAAG-D/DG155-67 | Same with Discharge Flange | | | | | | | | | | | | | |
| TTAAG-D/D, DG120-50 | 125 | 178 | 200 | 240 | 20 | 3 | 8-18 | 125 | 172 | 240 | 295 | 30 | 4.5 | 8-30 |
| TTAAG-D/D, DG155-30 | 150 | 212 | 240 | 285 | 24 | 3 | 8-22 | 150 | 203 | 250 | 300 | 34 | 4.5 | 8-26 |
| TTAAG-D/D280-43 | 200 | 268 | 295 | 340 | 28 | 3 | 8-22 | 200 | 259 | 320 | 375 | 38 | 4.5 | 12-30 |
| TTAAG-D/D280-65 | 200 | 268 | 295 | 340 | 30 | 3 | 12-22 | 200 | 259 | 345 | 415 | 44 | 4.5 | 12-36 |
| TTAAG-D/D360-40 | 200 | 268 | 295 | 340 | 28 | 3 | 8-22 | 200 | 259 | 320 | 375 | 38 | 4.5 | 12-30 |
| TTAAG-D/D450-60 | 250 | 320 | 355 | 405 | 32 | 3 | 12-26 | 250 | 312 | 400 | 470 | 48 | 4.5 | 12-36 |
| TTAAG-D/D500-57 | 250 | 320 | 355 | 405 | 32 | 3 | 12-26 | 250 | 312 | 400 | 470 | 48 | 4.5 | 12-36 |
| TTAAG-D/D580-60 | 300 | 370 | 410 | 460 | 32 | 3 | 12-26 | 250 | 312 | 385 | 445 | 40 | 4.5 | 12-30 |
| TTAAG-D/D600-60 | 300 | 370 | 410 | 460 | 32 | 3 | 12-26 | 250 | 312 | 385 | 445 | 40 | 4.5 | 12-30 |
| TTAAG-D/D660-60 | 300 | 370 | 410 | 460 | 32 | 3 | 12-26 | 250 | 312 | 385 | 445 | 40 | 4.5 | 12-30 |
| TTAAG-D/D720-60 | 300 | 370 | 410 | 460 | 34 | 4 | 12-24 | 300 | 363 | 460 | 530 | 54 | 4.5 | 12-39 |
| TTAAG 80D (DG) -30 | 80 | 135 | 160 | 195 | 22 | 3 | 4-18 | 80 | 130 | 160 | 200 | 26 | 3 | 8-18 |
| TTAAG 80D (DG) 12 | 80 | 128 | 150 | 190 | 18 | 3 | 4-18 | 80 | 130 | 160 | 200 | 26 | 3 | 8-18 |
| TTAAG 100D (DG) 16 | 100 | 148 | 170 | 210 | 18 | 3 | 4-18 | 100 | 158 | 180 | 220 | 24 | 3 | 8-18 |
| TTAAG 100D45 | 100 | 148 | 170 | 210 | 24 | 3 | 8-18 | 100 | 158 | 190 | 235 | 30 | 4 | 8-22 |
| TTAAG 125D (DG) 25 | 125 | 178 | 200 | 240 | 20 | 3 | 8-18 | 125 | 175 | 220 | 270 | 30 | 4.5 | 8-26 |
| TTAAG 150D30 | 150 | 212 | 240 | 285 | 24 | 3 | 8-22 | 150 | 203 | 250 | 300 | 34 | 4.5 | 8-26 |
| TTAAG 200D43 | 200 | 268 | 295 | 340 | 28 | 3 | 8-22 | 200 | 259 | 320 | 375 | 38 | 4.5 | 12-30 |
| TTAAG 200D65 | 200 | 268 | 295 | 340 | 30 | 3 | 12-22 | 200 | 259 | 345 | 415 | 44 | 4.5 | 12-36 |

Note: Flanges of DF.DY.DM pumps are the same as D pump



TORONTECH™

TM

Torontech™ - North America
TEL: +1 (416) 368-2721
FAX: +1 (416) 981-7652
E-MAIL: sales@Torontech.com
WEB: www.Torontech.com

Please contact us for your nearest local office or distributor

Torontech Inc. - Canada
North American Headquarters
Tel: +1.416.368.2721
Fax: +1.416.981.7652
Email: sales@torontech.com
www.Torontech.com